

STATIC TORQUE: 20 Kg-m  
 RATED VOLTAGE: 12 VDC  
 RATED POWER: 50 WATTS

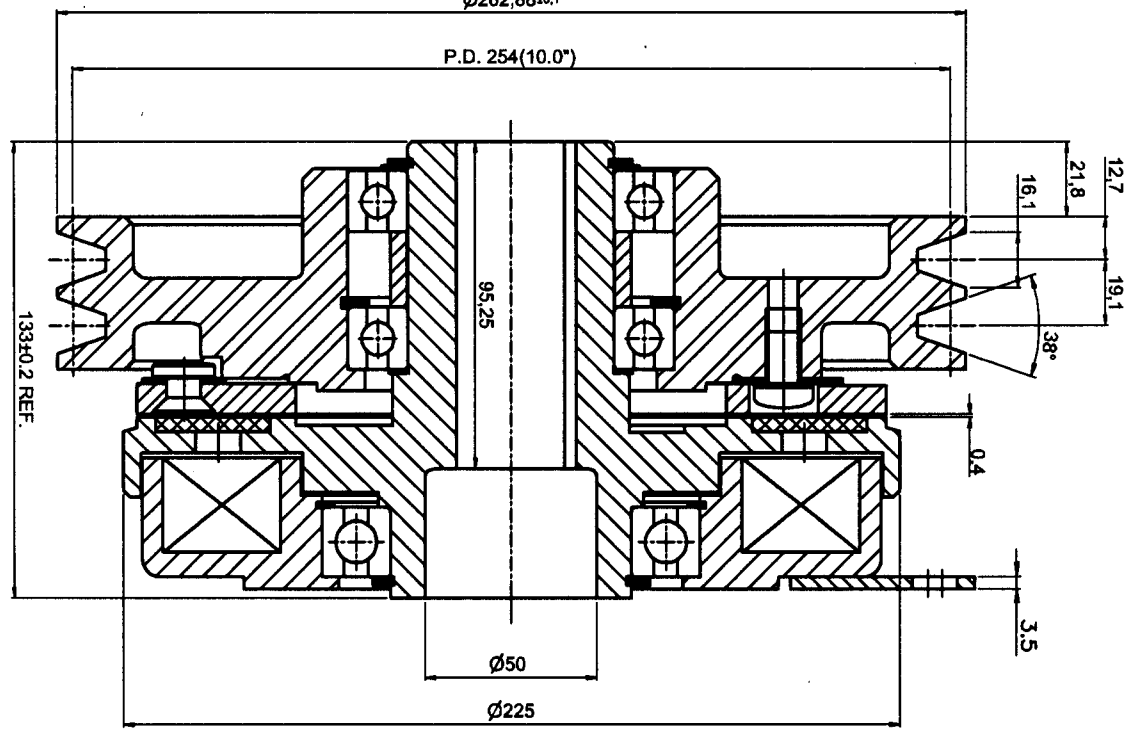

REV.	DESCRIPTION	DATE
1	CHANGE TERMINAL BLOCK	11-20-07

		FINISH	DRAWN	CHS	4-21-06
NEW TORQUE, INC.		CHECKED			
TITLE: SHAFT MOUNTED CLUTCH		SCALE: 1=1	UNITS: MM		
W/7/8"x2 GROOVE 10" P.D. PULLEY					
TYPE: SC-880-10 12VDC					
REV.		DATE			
B		11-20-07			
DWG. NO. 1632					